

Atexor code	SSFxxxx	
Certification	EESF 20 ATEX 086X IECEX EESF 21.0006X	
Certification marking	 II 2G Ex mb op is IIC T5 Gb (24-42V)	II 2G Ex mb op is IIC T4 Gb (110V-230V)
Manufacturing date	07/2021	
Product description	SLAM® Semic SF, EX LED luminary for fixed or portable use	
Temperature classification	T5 or T4	
Operating temperature	-20°C ... +40°C	
Light source	1 LED module	
Light emitted at source	1050 lm (measured)	
Luminous flux	650 lm +/- 10%	
Colour temperature	5000K +/- 10%	
Colour rendering index	>80	
Photobiological safety	Exempt group (No marking required, safe in normal use)	
Supply Voltage (min-max)	24-42VAC/DC, -20%...+10% 110VAC/DC 230VAC	
Supply Current typical	375mA (24V) 80mA (110V)	215mA (42V) 40mA (230V)
Electrical class	24-42V 3P Class III	110-230V Class I
Input power (P)	9W	
Cable	H07RN-F 3x1,5mm <sup>2</sup> 10m	
Plug options	ATX, CEAG, STAHL, MARECHAL	
Enclosure	Aluminium, polycarbonate	
Ingress protection	IP68	
Weight (with cable and accessories)	1,01 kg	
Accessories	2x Mounting clip	

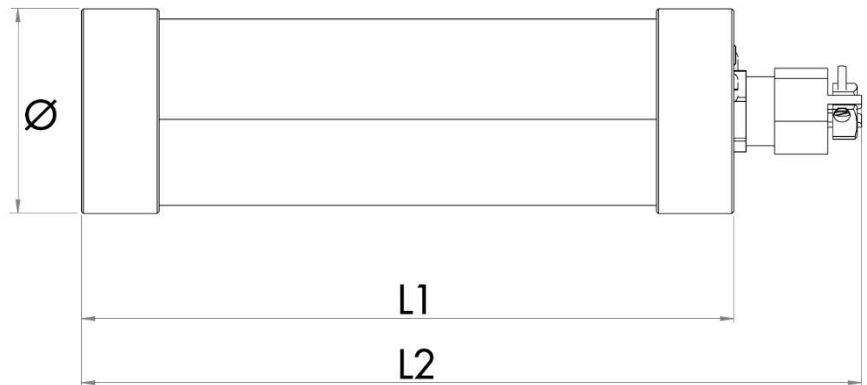

Product	Dimensions / mm		
	L1	L2	Ø
SLAM® Semic SF	160	192	50

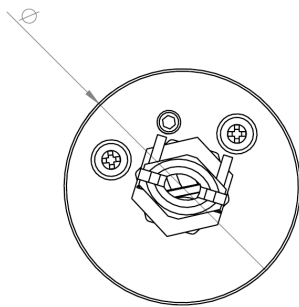

## Horizontal isolux curve

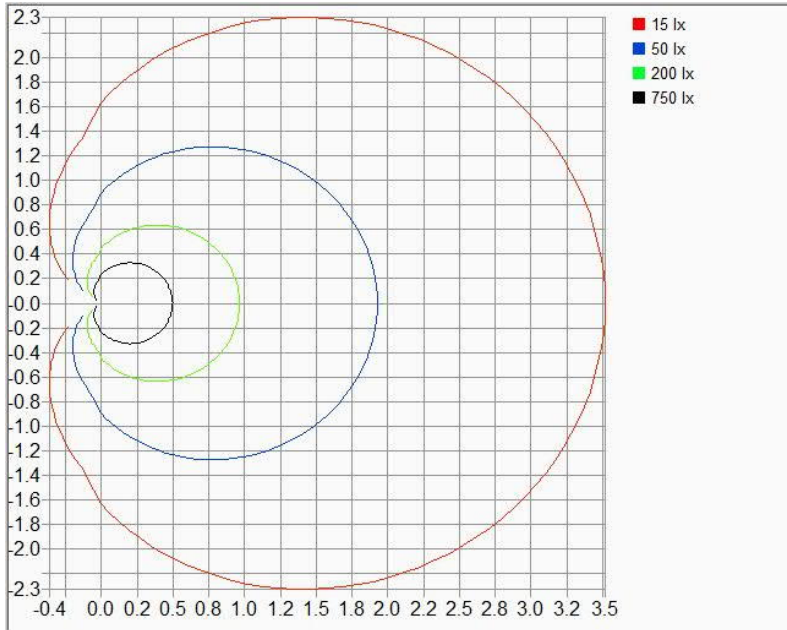

## Vertical isolux curve

